

Professionally Owned & Managed by:



# 1400 MORSE AVENUE

Elk Grove Village, IL



## 91,937 SF INDUSTRIAL BUILDING AVAILABLE

- Clear Height:** 20'
- Office:** 9,769 SF (can be reduced)
- Loading:** 8 Interior Docks  
1 Drive-In Door
- Power:** 1200 Amps
- Parking:** 98 Cars

### CONTACT:

**Terry Herlihy**

+1 630 693 0664  
therlihy@hiffman.com

**Mark Baumhart, CCIM**

+1 630 691 0550  
mbaumhart@hiffman.com

**Harrison Taylor**

+1 331 643 0313  
htaylor@hiffman.com



# 1400 MORSE AVENUE

Elk Grove Village, IL

Professionally Owned & Managed by:

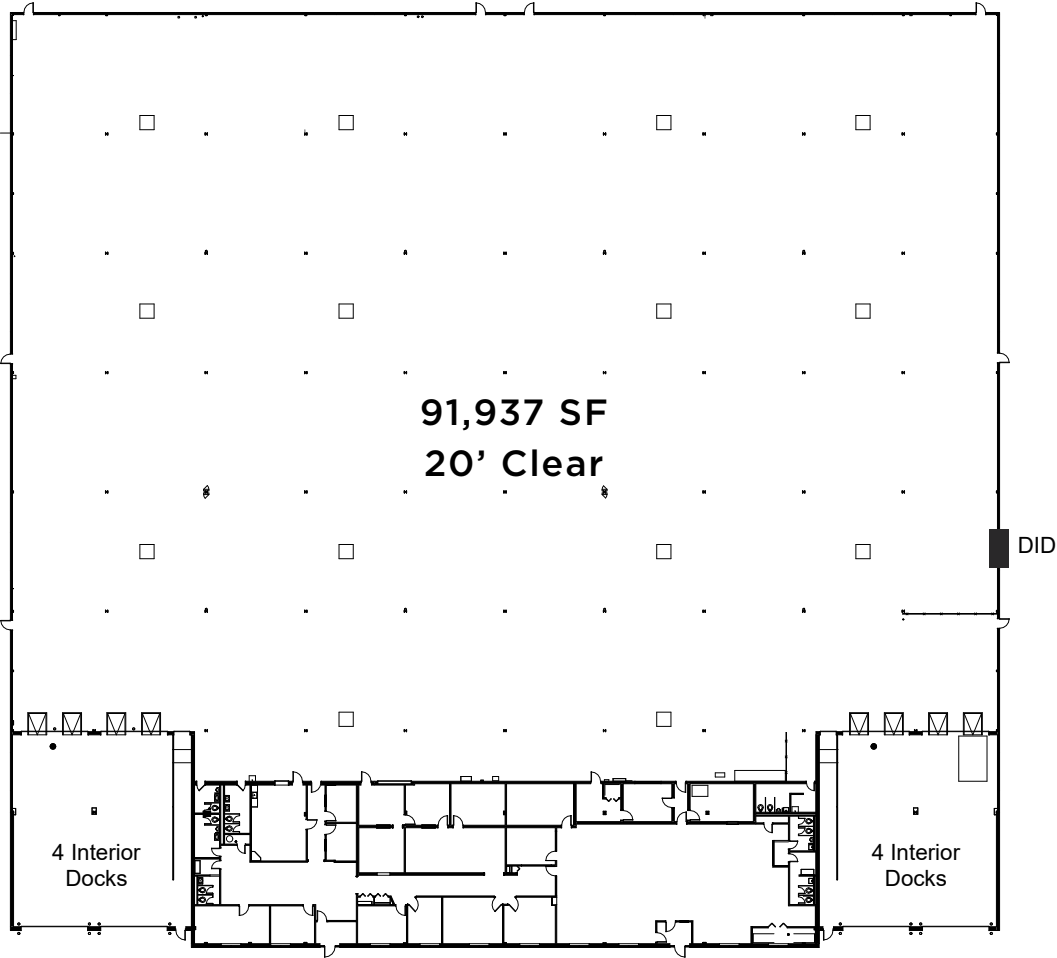

- Minutes to O'Hare International Airport and North & South Cargo Entrances
- I-390 (1.7 miles) / I-90 (2.2 miles) / I-290 (4.0 miles)
- Flexible office layout (can be reduced)
- New 6B Tax Incentive
- New façade, roof, parking lot, drive aprons, and landscaping

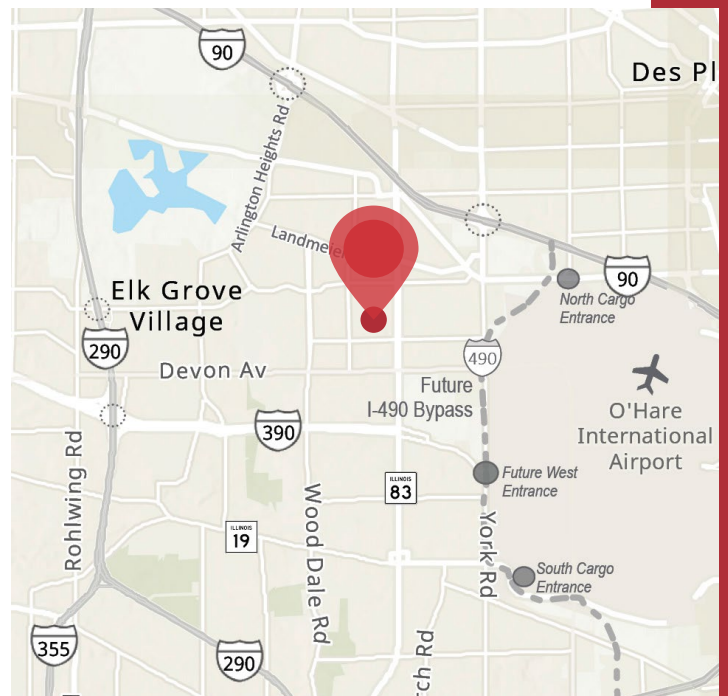

**NAL Hiffman**  
Commercial Real Estate Services, Worldwide

One Oakbrook Terrace Suite 400  
Oakbrook Terrace, Illinois 60181  
+1 630 932 1234 [hiffman.com](http://hiffman.com)