

Professionally Owned & Managed by:



1400 MORSE AVENUE

Elk Grove Village, IL



91,937 SF INDUSTRIAL BUILDING AVAILABLE

- Clear Height:** 20'
- Office:** 9,769 SF (can be reduced)
- Loading:** 8 Interior Docks
1 Drive-In Door
- Power:** 1200 Amps
- Parking:** 98 Cars

CONTACT:

Terry Herlihy

+1 630 693 0664
therlihy@hiffman.com

Mark Baumhart, CCIM

+1 630 691 0550
mbaumhart@hiffman.com

Harrison Taylor

+1 331 643 0313
htaylor@hiffman.com



1400 MORSE AVENUE

Elk Grove Village, IL

Professionally Owned & Managed by:

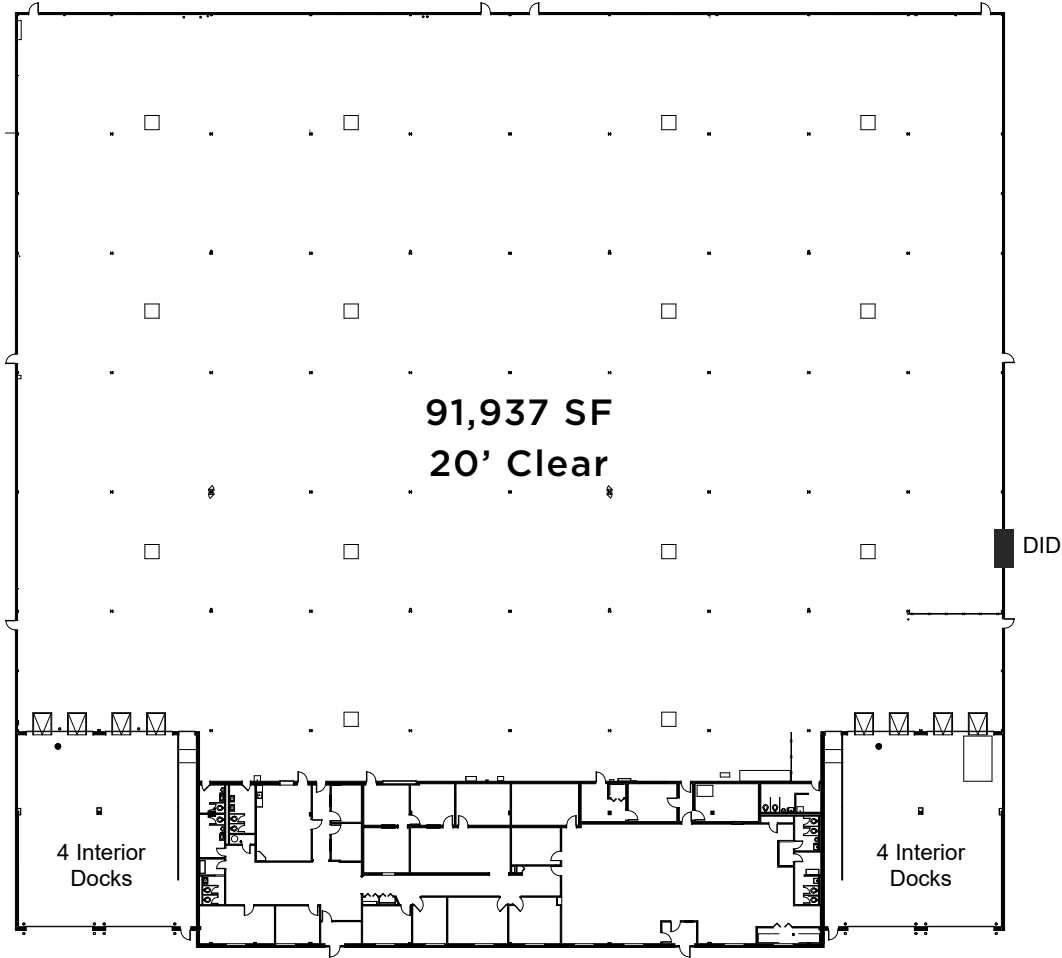

- Minutes to O'Hare International Airport and North & South Cargo Entrances
- I-390 (1.7 miles) / I-90 (2.2 miles) / I-290 (4.0 miles)
- Flexible office layout (can be reduced)
- New 6B Tax Incentive
- New façade, roof, parking lot, drive aprons, and landscaping

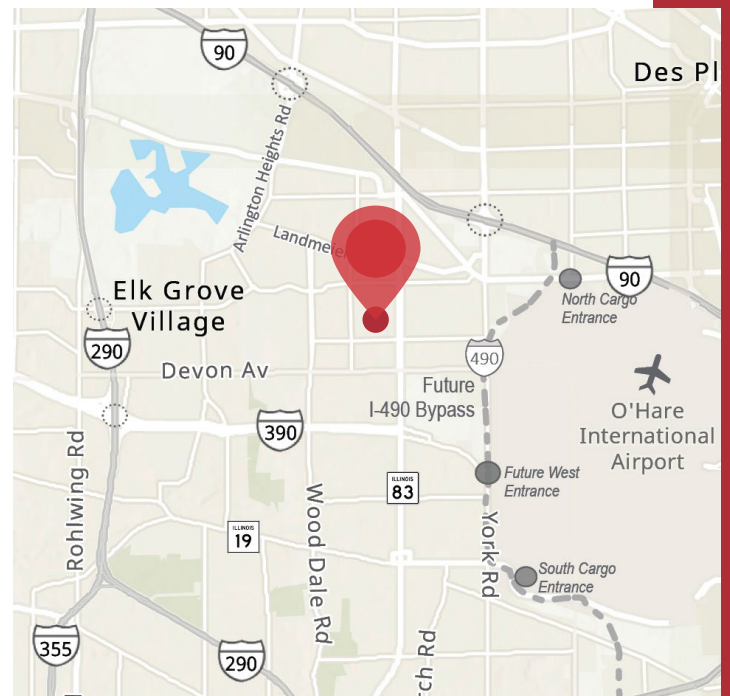

NAL Hiffman
Commercial Real Estate Services, Worldwide

One Oakbrook Terrace Suite 400
Oakbrook Terrace, Illinois 60181
+1 630 932 1234 hiffman.com

No warranty or representation, expressed or implied, is made as to the accuracy of the information contained herein, and the same is submitted subject to errors, omissions, change of price, rental or other conditions, prior sale, lease or financing, or withdrawal without notice, and of any special listing conditions imposed by our principals no warranties or representations are made as to the condition of the property or any hazard contained therein are any to be implied.